

TENDRING DISTRICT COUNCIL

Application to vary a premises licence under the Licensing Act 2003

PLEASE READ THE FOLLOWING INSTRUCTIONS FIRST

Before completing this form please read the guidance notes at the end of the form. If you are completing this form by hand please write legibly in block capitals. In all cases ensure that your answers are inside the boxes in black ink. Use additional sheets if necessary. You may wish to keep a copy of the completed form for your records.

I / We DEEPAK PATEL....., being the premises
(Insert name(s) of applicant)

licence holder, apply to vary a premises licence under section 34 of the Licensing Act 2003 for the premises described in Part 1 below

Premises licence number

19/00020/PREMTR

Part 1 – Premises Details

Postal address of premises or, if none, ordnance survey map reference, or description	
THE PLOUGH PLOUGH ROAD GREAT BENTLEY	
Post town	Post code
COLCHESTER	CO7 8LA

Telephone number at premises (if any)

01206 255 242

Non-domestic rateable value of premises

£ 0.00

Part 2 – Applicant Details

Daytime contact telephone number

01255 255 242

E-mail address (optional)

accounts@deesgroup.co.uk

Current address if different from premises address

[Empty box for current address]

Post Town

[Empty box for Post Town]

Post Code

[Empty box for Post Code]

Part 3 – Variation

Please tick ✓ Yes

Do you want the proposed variation to have effect as soon as possible?

If not do you want the variation to take effect from

Day	Month	Year

If your proposed variation would mean that 5,000 or more people are expected to attend the premises at any one time, please state the number expected to attend

Please describe briefly the nature of the proposed variation (please see guidance note 1)

INCLUDE CAR PARK + REAR GARDEN UNDER LICENCED PREMISES. LIVE MUSIC UNTIL MIDNIGHT FRIDAYS + SATURDAYS.

Part 4 – Operating Schedule

Please complete those parts of the Operating Schedule below which would be subject to change if this application to vary were successful

Please tick ✓

Provision of regulated entertainment

- a) plays (if ticking yes, fill in box A)
- b) films (if ticking yes, fill in box B)
- c) indoor sporting events (if ticking yes, fill in box C)
- d) boxing or wrestling entertainment (if ticking yes, fill in box D)
- e) live music (if ticking yes, fill in box E)
- f) recorded music (if ticking yes, fill in box F)
- g) performance of dance (if ticking yes, fill in box G)
- h) anything of a similar description to that within (e), (f) or (g) (if ticking yes, fill in box H)

Provision of entertainment facilities:

- i) making music (if ticking yes, fill in box I)
- j) dancing (if ticking yes, fill in box J)
- k) entertainment of a similar description to that falling within (i) or (j) (if ticking yes, fill in box K)

Provision of late night refreshment (if ticking yes, fill in box L)

Sale by retail of alcohol (if ticking yes, fill in box M)

In all cases complete boxes N, O and P

A

Plays Standard days and timings (please read guidance note 6)			Will the performance of a play take place indoors or outdoors or both – please tick [✓] (please read guidance note 2).	Indoors			
				Outdoors			
				Both			
Day	Start	Finish	<u>Please give further details here</u> (please read guidance note 3)				
Mon							
Tue							
Wed				<u>State any seasonal variations for performing plays</u> (please read guidance note 4)			
Thur							
Fri					<u>Non standard timings. Where you intend to use the premises for the performance of plays at different times to those listed in the column on the left, please list</u> (please read guidance note 5)		
Sat							
Sun							

B

Films Standard days and timings (please read guidance note 6)			Will the exhibition of films take place indoors or outdoors or both – please tick [✓] (please read guidance note 2).	Indoors			
				Outdoors			
				Both			
Day	Start	Finish	<u>Please give further details here</u> (please read guidance note 3)				
Mon							
Tue							
Wed				<u>State any seasonal variations for the exhibition of films</u> (please read guidance note 4)			
Thur							
Fri					<u>Non standard timings. Where you intend to use the premises for the exhibition of films at different times to those listed in the column on the left, please list</u> (please read guidance note 5)		
Sat							
Sun							

C

Indoor sporting event Standard days and timings (please read guidance note 6)			<u>Please give further details here</u> (please read guidance note 3)
Day	Start	Finish	
Mon			
Tue			<u>State any seasonal variations for indoor sporting events</u> (please read guidance note 4)
Wed			
Thur			<u>Non standard timings. Where you intend to use the premises for indoor sporting events at different times to those listed in the column on the left, please list</u> (please read guidance note 5)
Fri			
Sat			
Sun			

D

Boxing or wrestling entertainment Standard days and timings (please read guidance note 6)			Will boxing or wrestling entertainment take place indoors or outdoors or both – please tick [✓] (please read guidance note 2).	Indoors	
				Outdoors	
				Both	
Day	Start	Finish			
Mon			<u>Please give further details here</u> (please read guidance note 3)		
Tue			<u>State any seasonal variations for the boxing or wrestling entertainment</u> (please read guidance note 4)		
Wed					
Thur			<u>Non standard timings. Where you intend to use the premises for boxing or wrestling entertainment at different times to those listed in the column on the left, please list</u> (please read guidance note 5)		
Fri					
Sat					
Sun					

E

Live music Standard days and timings (please read guidance note 6)			Will the performance of live music take place indoors or outdoors or both – please tick [✓] (please read guidance note 2).	Indoors	<input type="checkbox"/>
				Outdoors	<input type="checkbox"/>
				Both	<input checked="" type="checkbox"/>
Day	Start	Finish	<u>Please give further details here</u> (please read guidance note 3)		
Mon					
Tue					
			<u>State any seasonal variations for the performance of live music</u> (please read guidance note 4)		
Wed					
Thur					
			<u>Non standard timings. Where you intend to use the premises for the performance of live music at different times to those listed in the column on the left, please list</u> (please read guidance note 5)		
Fri					
	14:00	00:00			
Sat					
	14:00	00:00			
Sun					
	14:00	21:00			

F

Recorded music Standard days and timings (please read guidance note 6)			Will the playing of recorded music take place indoors or outdoors or both – please tick [✓] (please read guidance note 2).	Indoors	<input type="checkbox"/>
				Outdoors	<input type="checkbox"/>
				Both	<input type="checkbox"/>
Day	Start	Finish	<u>Please give further details here</u> (please read guidance note 3)		
Mon					
Tue					
			<u>State any seasonal variations for playing recorded music</u> (please read guidance note 4)		
Wed					
Thur					
			<u>Non standard timings. Where you intend to use the premises for the playing of recorded music entertainment at different times to those listed in the column on the left, please list</u> (please read guidance note 5)		
Fri					
Sat					
Sun					

G

Performance of dance Standard days and timings (please read guidance note 6)			Will the performance of dance take place indoors or outdoors or both – please tick [✓] (please read guidance note 2).	Indoors	
				Outdoors	
				Both	
Day	Start	Finish	<u>Please give further details here</u> (please read guidance note 3)		
Mon					
Tue			<u>State any seasonal variations for the performance of dance</u> (please read guidance note 4)		
Wed					
Thur			<u>Non standard timings. Where you intend to use the premises for the performance of dance entertainment at different times to those listed in the column on the left, please list</u> (please read guidance note 5)		
Fri					
Sat					
Sun					

H

Anything of a similar description to that falling within (e), (f) or (g) Standard days and timings (please read guidance note 6)			<u>Please give a description of the type of entertainment you will be providing</u>		
Day	Start	Finish	Will the entertainment take place indoors or outdoors or both – please tick [✓] (please read guidance note 2).	Indoor	
				Outdoor	
Mon				Both	
			<u>Please give further details here</u> (please read guidance note 3)		
Tue			<u>State any seasonal variations for the entertainment of a similar description to that falling within (e), (f) or (g).</u> (please read guidance note 4)		
Wed					
Thur			<u>Non standard timings. Where you intend to use the premises for the entertainment of similar description that falling within (e), (f) or (g) at different times to those listed in the column on the left, please list</u> (please read guidance note 5)		
Fri					
Sat					
Sun					

I

Provision of facilities for making music Standard days and timings (please read guidance note 6)			<u>Please give a description of the facilities for making music you will be providing</u>		
Day	Start	Finish	Will the facilities for making music be indoors or outdoors or both – please tick [✓] (please read guidance note 2).	Indoor	
Mon				Outdoor	
			Both		
			<u>Please give further details here</u> (please read guidance note 3)		
Tue					
Wed					
			<u>State any seasonal variations for the provision of facilities for making music</u> (please read guidance note 4)		
Thur					
Fri					
			<u>Non standard timings. Where you intend to use the premises for provision of facilities for making music entertainment at different times to those listed in the column on the left, please list</u> (please read guidance note 5)		
Sat					
Sun					

J

Provision of facilities for dancing Standard days and timings (please read guidance note 6)			Will the facilities for dancing be indoors or outdoors or both – please tick [✓] (please read guidance note 2).	Indoors	
				Outdoors	
			Both		
Day	Start	Finish	<u>Please give a description of the facilities for dancing you will be providing</u>		
Mon			<u>Please give further details here</u> (please read guidance note 3)		
Tue					
			<u>State any seasonal variations for providing dancing facilities</u> (please read guidance note 4)		
Wed					
Thur					
			<u>Non standard timings. Where you intend to use the premises for the provision of facilities for dancing entertainment at different times to those listed in the column on the left, please list</u> (please read guidance note 5)		
Fri					
Sat					
Sun					

K

Provision of facilities for entertainment of a similar description to that falling within I or J Standard days and timings (please read guidance note 6)			<u>Please give a description of the type of entertainment facility you will be providing facilities</u>		
Day	Start	Finish	Will the entertainment facility be indoors or outdoors or both – please tick [✓] (please read guidance note 2).	Indoor	
				Outdoor	
Mon				Both	
			<u>Please give further details here</u> (please read guidance note 3)		
Tue					
Wed					
			<u>State any seasonal variations for the provision of facilities for entertainment of a similar description to that falling with I or J</u> (please read guidance note 4)		
Thur					
Fri					
			<u>Non standard timings. Where you intend to use the premises for provision of facilities for entertainment of a similar description to that falling within I or J at different times to those listed in the column on the left, please list</u> (please read guidance note 5)		
Sat					
Sun					

L

Late night refreshment Standard days and timings (please read guidance note 6)			Will the provision of late night refreshment take place indoors or outdoors or both – please tick [✓] (please read guidance note 2).			Indoors	
				Outdoors			
				Both			
Day	Start	Finish	<u>Please give further details here</u> (please read guidance note 3)				
Mon							
Tue							
Wed			<u>State any seasonal variations for the provision of late night refreshment</u> (please read guidance note 4)				
Thur							
Fri			<u>Non standard timings. Where you intend to use the premises for the provision of late night refreshment at different times to those listed in the column on the left, please list</u> (please read guidance note 5)				
Sat							
Sun							

M

Supply of alcohol Standard days and timings (please read guidance note 6)			Will the sale of alcohol be for consumption (please tick [✓] box) (please read guidance note 7)		On the premises	
					Off the premises	
					Both	
Day	Start	Finish	State any seasonal variations for the supply of alcohol (please read guidance note 4)			
Mon						
Tue						
Wed						
Thur						
Fri						
Sat						
Sun						
			Non standard timings. Where you intend to use the premises for the supply of alcohol at different times to those listed in the column on the left, please list (please read guidance note 5)			

N

<p>Please highlight any adult entertainment or services, activities, other entertainment or matters ancillary to the use of the premises that may give rise to concern in respect of children (please read guidance note 8)</p>
--

O

Hours premises are open to the public Standard days and timings (please read guidance note 6)			State any seasonal (please read guidance note 4)
Day	Start	Finish	
Mon			
Tue			
Wed			
Thur			
Fri			
Sat			
Sun			
			Non standard timings. Where you intend to use the premises to be open to the public at different times from those listed in the column on the left, please list (please read guidance note 5)

Please identify those conditions currently imposed on the licence which you believe could be removed as a consequence of the proposed variation you are seeking

Please tick ✓ yes

I have enclosed the premises licence

I have enclosed the relevant part of the premises licence

If you have not ticked one of these boxes please fill in reasons for not including the licence, or part of it below.

Reasons why I have failed to enclose the premises licence or relevant part of premises licence

P

Describe any additional steps you intend to take to promote the four licensing objectives as a result of the proposed variation:

a) General – all four licensing objectives (b,c,d,e) (please read guidance note 9)

MONITORING START AND FINISH TIMES OF LIVE MUSIC. KEEPING DOORS CLOSED TO LIMIT NOISE.

b) The prevention of crime and disorder

CCTV
STAFF TRAINING

c) Public safety

HEALTH + SAFETY

d) The prevention of public nuisance

STAFF TRAINING
NO SALE OF ALCOHOL TO INTOXICATED CUSTOMERS

e) The protection of children from harm

STAFF TRAINING

Please tick ✓ Yes

- I have made or enclosed payment of the fee
- I have sent copies of this application and the plan to responsible authorities and others where applicable
- I understand that I must now advertise my application
- I have enclosed the premises licence or relevant part of it or explanation
- I understand that if I do not comply with the above requirement my application will be rejected

IT IS AN OFFENCE, LIABLE ON CONVICTION TO A FINE UP TO LEVEL 5 ON THE STANDARD SCALE, UNDER SECTION 158 OF THE LICENSING ACT 2003 TO MAKE A FALSE STATEMENT IN OR IN CONNECTION WITH THIS APPLICATION.

Part 5 – Signatures (please read guidance note 10)

Signature of applicant (the current premises licence holder) or applicant's solicitor or other duly authorised agent. (See guidance note 11) If signing on behalf of the applicant please state in what capacity.

Signature: *Deen Patel*
Date: *28-08-2019*
Capacity: *OWNER*

Where the premises licence is jointly held signature of 2nd applicant (the current premises licence holder) or 2nd applicant's solicitor or other authorised agent. (please read guidance note 12) If signing on behalf of the applicant please state in what capacity.

Signature:
Date:
Capacity:

Contact name (where not previously given) and address for correspondence associated with this application (please read guidance note 13)

*MR. DEEPAK PATEL
FLAVANT GREAT BENTLEY CO
FLAVANT PUB
FLAVANT RD GT. BENTLEY ESSEX CO7 8LA*

Post town *GT. BENTLEY* Post code *CO7 8LA*

Telephone number (if any) *07811 854 828*

Email address - If you would prefer us to correspond with you by email (optional)
dpatel @ deesgroup.co.uk

[Symbol]	Retention Pond
[Symbol]	Existing structure (not proposed)
[Symbol]	MFL/Asphalt overlayer

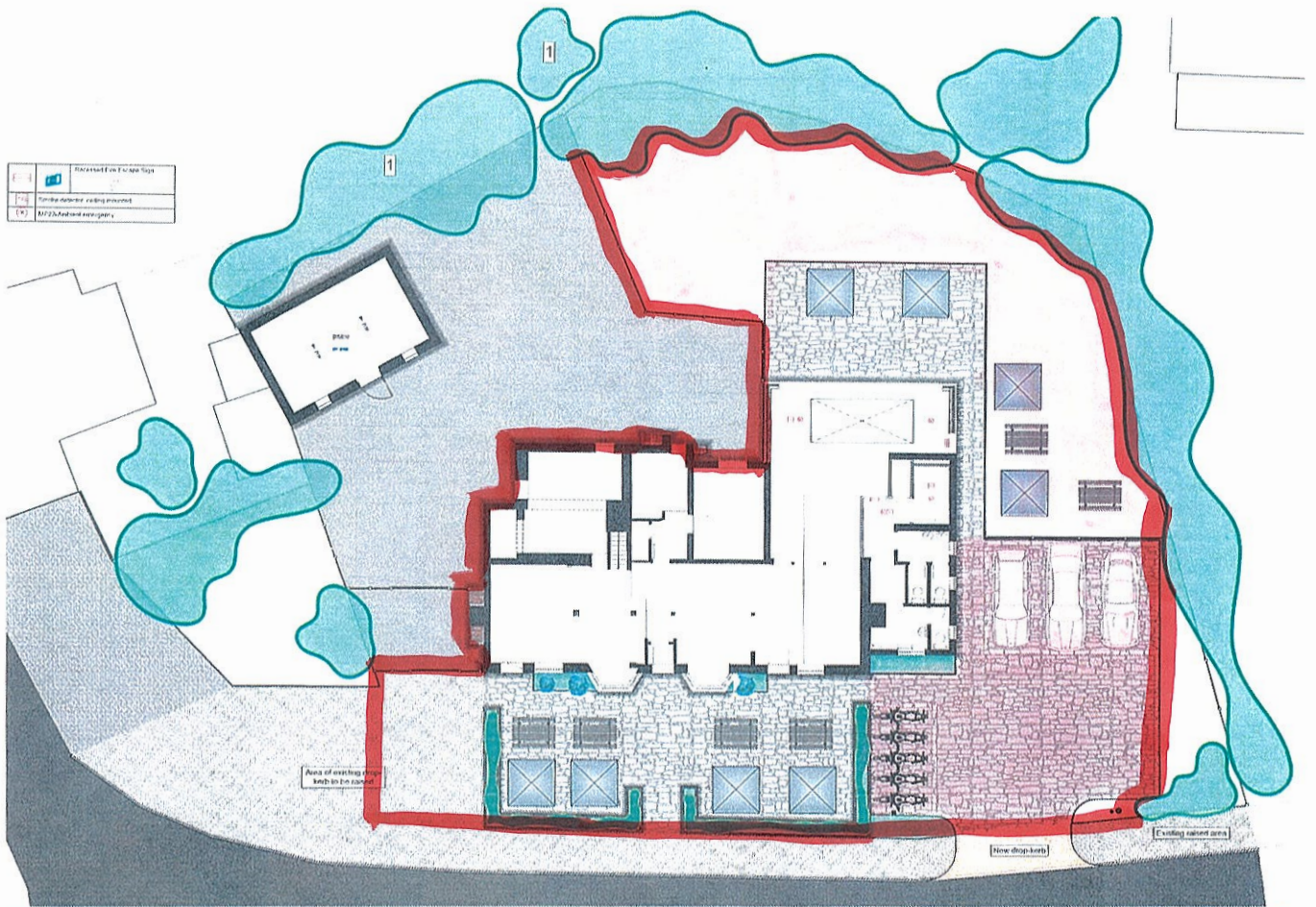

Architecture design limited
 The James Group
 The Waterfront
 Chester
 CH1 1AF

Architectural drawings are to be used only for the purpose of information and are not to be used for construction purposes. The client is responsible for ensuring that the drawings are used for the intended purpose and for any necessary modifications.

Drawn by: [Name]
 Checked by: [Name]

Site name: The Phoenix
 Address: [Address]
 Date: [Date]

Site name: [Name]
 Address: [Address]
 Date: [Date]

Landscape arrangement
 1:100
 0 1 2 3 4 5 6